

1. Proposed Second Floor Plan 1:50

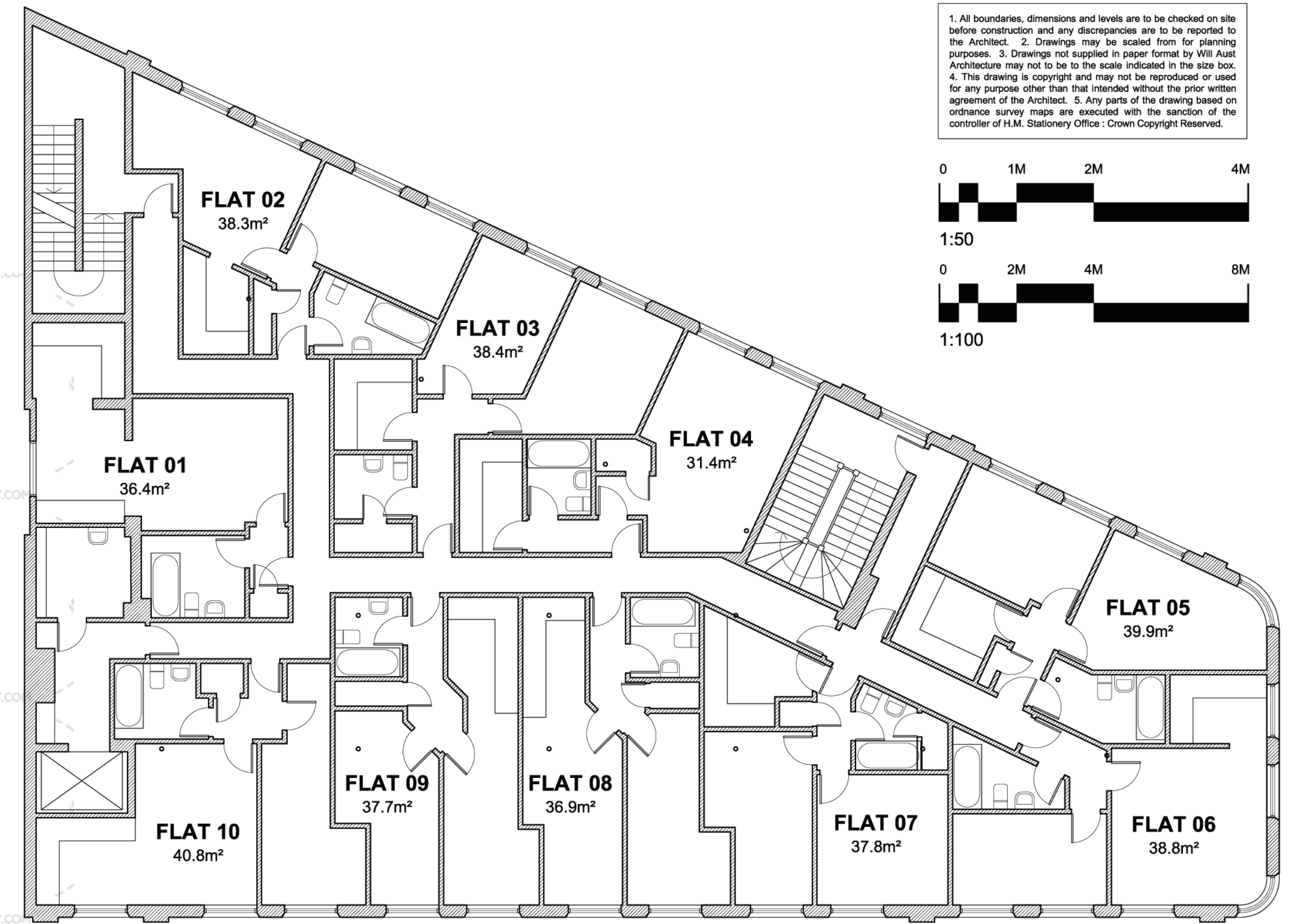

2. Existing Second Floor Plan 1:100

1. All boundaries, dimensions and levels are to be checked on site before construction and any discrepancies are to be reported to the Architect. 2. Drawings may be scaled from for planning purposes. 3. Drawings not supplied in paper format by Will Aust Architecture may not be to the scale indicated in the size box. 4. This drawing is copyright and may not be reproduced or used for any purpose other than that intended without the prior written agreement of the Architect. 5. Any parts of the drawing based on Ordnance Survey maps are executed with the sanction of the controller of H.M. Stationery Office: Crown Copyright Reserved.

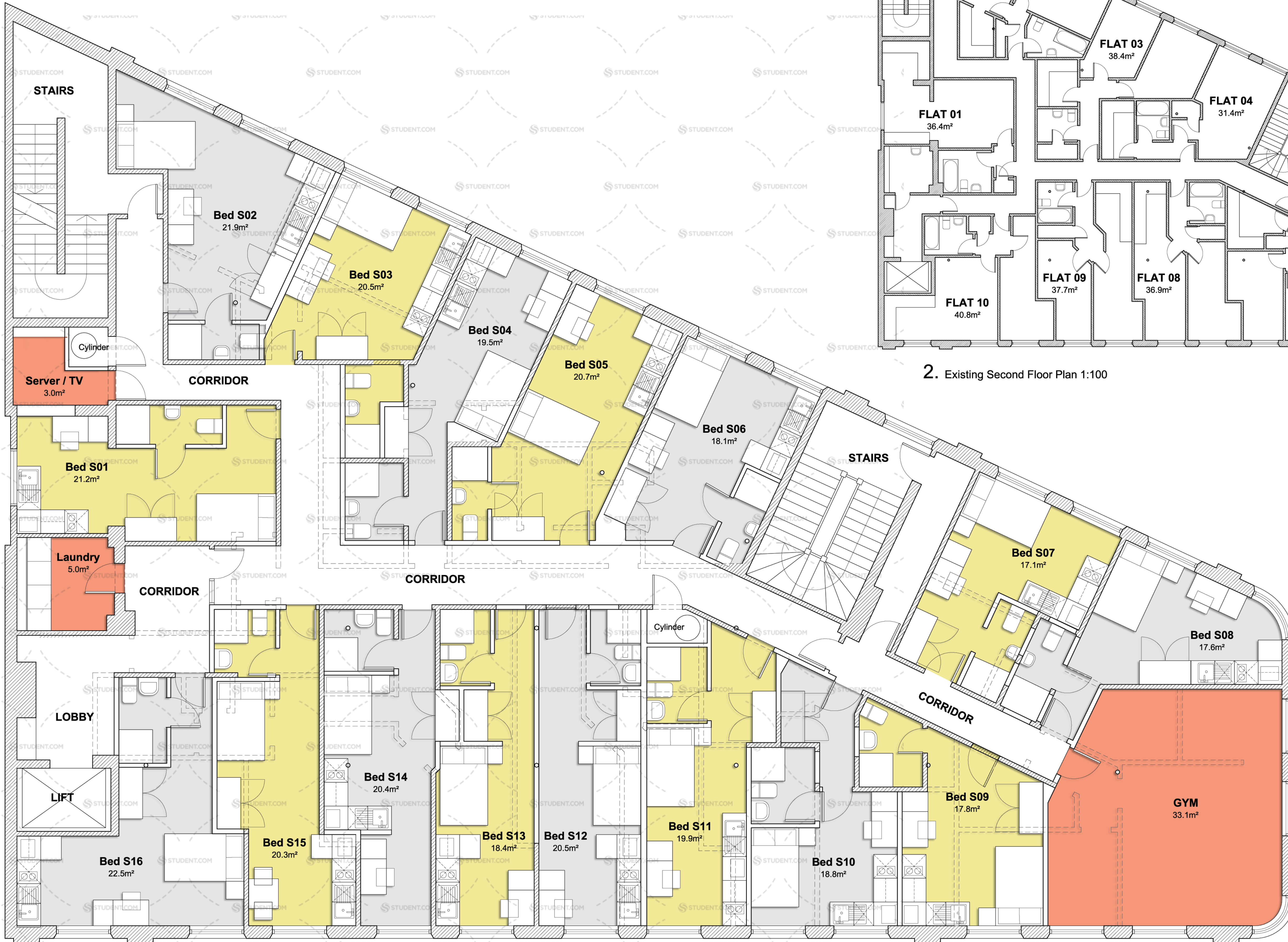
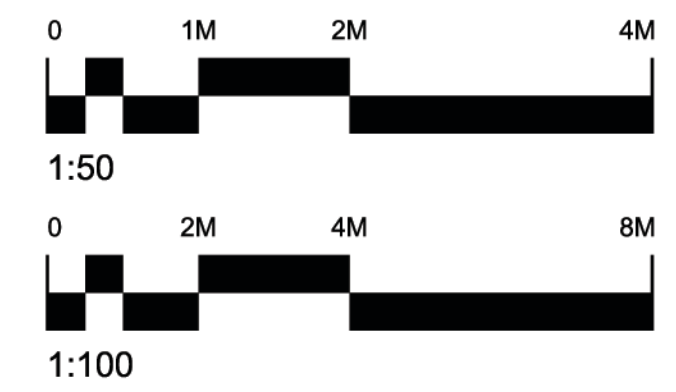

Rev	Date	Description	By	Chk

WILLAUSTARCHITECTURE

162 Julian Road
West Bridgford
Nottingham
NG2 5AN

t: 07738260093
e: will@willaust.co.uk

Client:
Simon Chamberlain,
Student Beehive

Project:
Carlton Building, 2-10 Broad Street,
Nottingham

Drawing title:
Proposed Second Floor Plan

Scale(s)	Size	First issue:	Drawn:
1:50	A1	18.03.22	WA
Job no:	Drawing no:	Rev:	
LTD72	12	B	

PLANNING